

## Features

- Design : Suspended Stripline
- Connectors
- Low Insertion Loss 1.0 dB
- High Rejection
- RoHS and REACH Compliant

## Electrical Specifications

Description	Units	Minimum	Typical	Maximum
Freq. Range	GHz	8	8.3	8.6
Bandwidth	MHz		600	
Insertion Loss	dB			1.0
Ripple	dB			1.0
Return Loss	dB	13.98		
Group delay	ns			/
Group Delay Variation	ns			
Phase Linearity	deg			±3Deg @8150-8450MHz
Amplitude Matching	dB			0.5dB (freq. points to freq. points)
Rejection	dB	40@16-20GHz		
Power	W			1
Operating Temp.	°C			

## Special Requirements

Changes: Rejection changed from 50@16-20GHz to 40@16-20GHz.

## Note

- Electronic Specification Note : Values at 25deg , sea level. Test indicators will deteriorate at high and low temperature ;
- Relative Humidity 5 to 95% at +25°C ;

**Mechanical Specifications**

Dimension L*W*H	42*15*10 mm
Input Connector	SMA-Female
Output Connectors	SMA-Female
Weight	TBD g
Finishing	
Environment	X

**Compliance Certifications**

RoHS Compliant	✓
REACH Compliant	✓

**CAD Drawing**

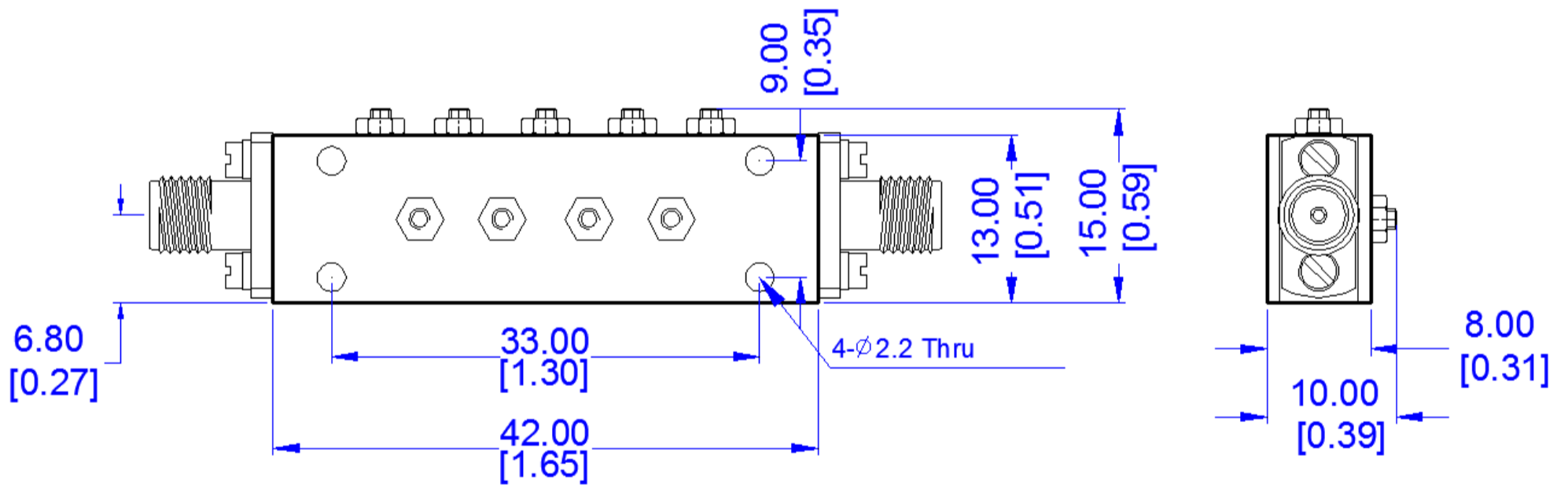

Dimensions are in mm [Inches]  
 Tolerances : Outline drawing: ±0.2 [0.008]  
 Hole: ±0.2 [0.008]